

MOCREO®

MOCREO Product Brochure



• *Real-time monitoring for peace of mind* •



 mocreo.com

 +1 (530) 988-8608

 b2b@mocreo.com

About MOCREO

MOCREO provides versatile sensing products designed to capture essential data from the physical world. By leveraging innovative IoT technology, we deliver real-world impact across diverse applications. Our commitment to offering cutting-edge solutions addresses the dynamic needs of our customers, ensuring reliable environmental monitoring in various settings. With MOCREO, you can always have peace of mind.

10+ Year
Since 2014.

With years of exploration in the IoT solutions, MOCREO stands out as the innovator in IoT field for anyone.

45%
R&D Engineers

We pay much attention to the research & Development of our products, always aiming at presenting the most reliable and high performance solutions to our customers.

50+ Thousands
Sold Sensors

Support Customers 10+ Thousands

MOCREO Technologies



Real-time Monitoring

Based on the Sensors and IoT technology, MOCREO system offers 24/7 real-time monitoring, ensuring immediate detection of environmental (e.g. temperature, humidity, water) changes being monitored.

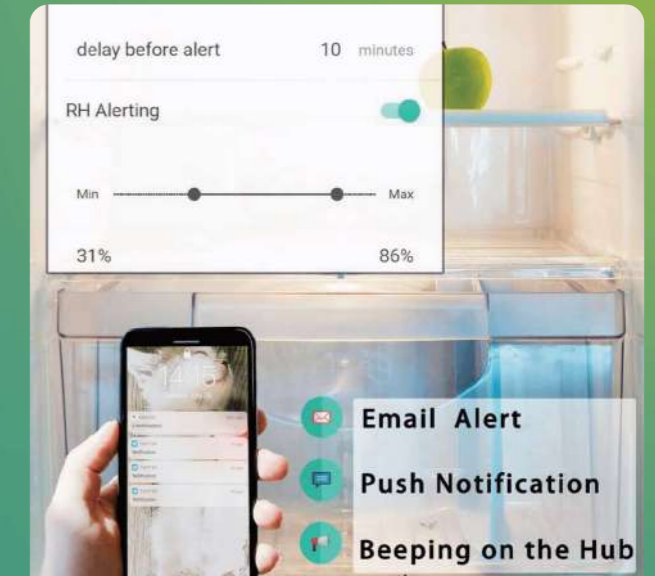

Remote & Local Alert

The system provides immediate notifications via email, and in-app alerts, ensuring prompt response to environmental deviations whether you are on-site or off-site, preventing potential losses.



Low Battery Consumption

Based on the Low Battery Consumption Technology, make the battery of the Sensor last 1.5~2 years long per charge.



Data Logging & Exporting

Automatically log historical data, accessible through the MOCREO Cloud. Easily export data in various formats for analysis, reporting, or regulatory compliance.

Why MOCREO Solution

Long Lasting Battery: 2 years battery life



Truly Wire Free Installation

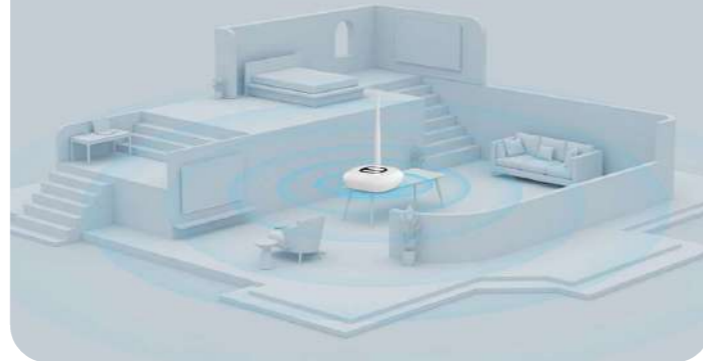

Professional Technology

Easy To Setup & Scale



0 Monthly Fee

Architecture Overview

MOCREO Sensors capture the essential data from the physical world, then send it to the Hub. The Hub sends the data to the MOCREO Cloud. User can check all the insights of their MOCREO devices through MOCREO App/Web Portal.

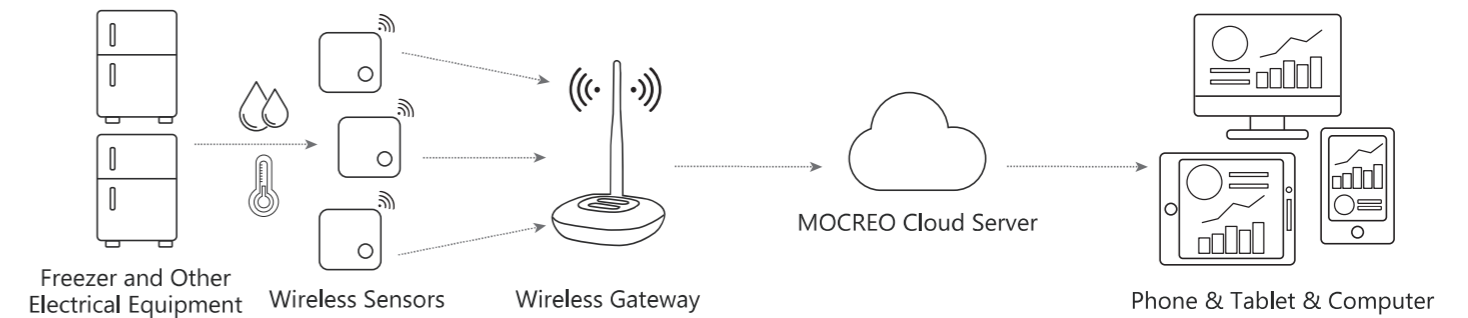

Architecture

Benefit

With MOCREO, you will



Realize the remote monitoring in real time



Foresee the potential risk and alert in time



Replace the tradition manual recording



Reduce the loss and the unnecessary cost

MOCREO Cloud

MOCREO Cloud makes it possible to remote monitor your MOCREO sensors over internet. MOCREO Cloud offers a range of powerful features:



Real-time Data Visualization

Monitor temperature, humidity, water leaks, and other environmental parameters in real-time from anywhere in the world.



Reliable Alerts

Receive customizable alerts (App Notification, Email Alert, Local buzzer, etc.) for critical environmental changes, ensuring prompt action.



Historical Data Analysis

Access up to 2 years of historical data for in-depth analysis and insights.



User-friendly App & Web Dashboard

Utilize a user-friendly App/Web dashboard for comprehensive data management and visualization.



Multi User Management

Allow you to create admin and guest accounts to better suit the monitoring and running process.

MOCREO Software

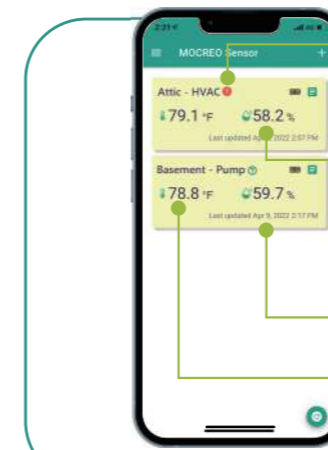

Alarm Signs

Humidity

Last Updated Timestamp

Temperature



App Notification

E-mail Alert

Graph

Time Period

Refresh Button

Setting Button

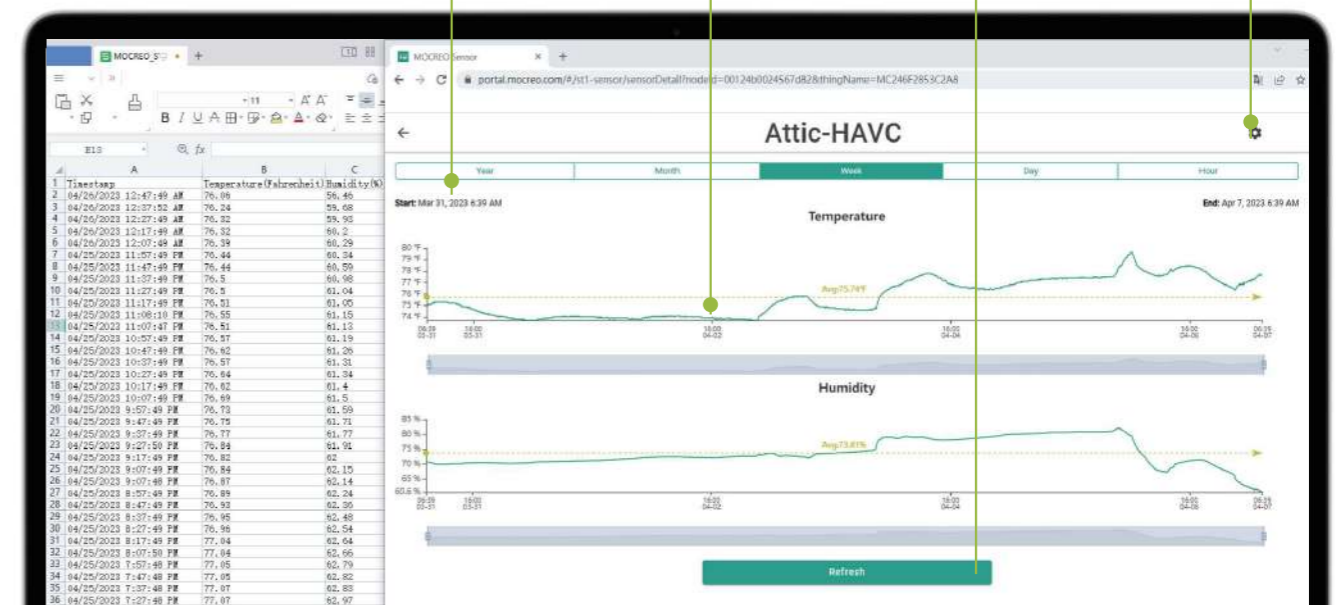

IoT Hub

IoT Hub (H1B) is a data-collecting device. It is intended to remotely or wirelessly gather data from nearby IoT Sensors and then transfer them to the cloud server through the Internet.



- Hub Fleet for Better Blind Spot Coverage
- Multiple Internet Connection Options
- 2.4GHz WiFi/Ethernet Connection
- Manager Up To 30 Sensors
- 80dB Hub Beep

H1B

Model	H1B
Dimensions	4.1 x 4.1 x 1.2 inches
Weight	3.80 ounces
Power	5V/1A USB Adapter
PAN TX Power	Up to 20dBm
Ethernet	10Mbps/100Mbps
Wi-Fi	2.4GHz 802.11b/g/n
PAN Wireless Communication	Bluetooth Low Energy

IoT Hub

IoT Hub (H2) is a data-collecting device. It is intended to remotely or wirelessly gather data from nearby IoT Sensors and then transfer them to the cloud server through the Internet.

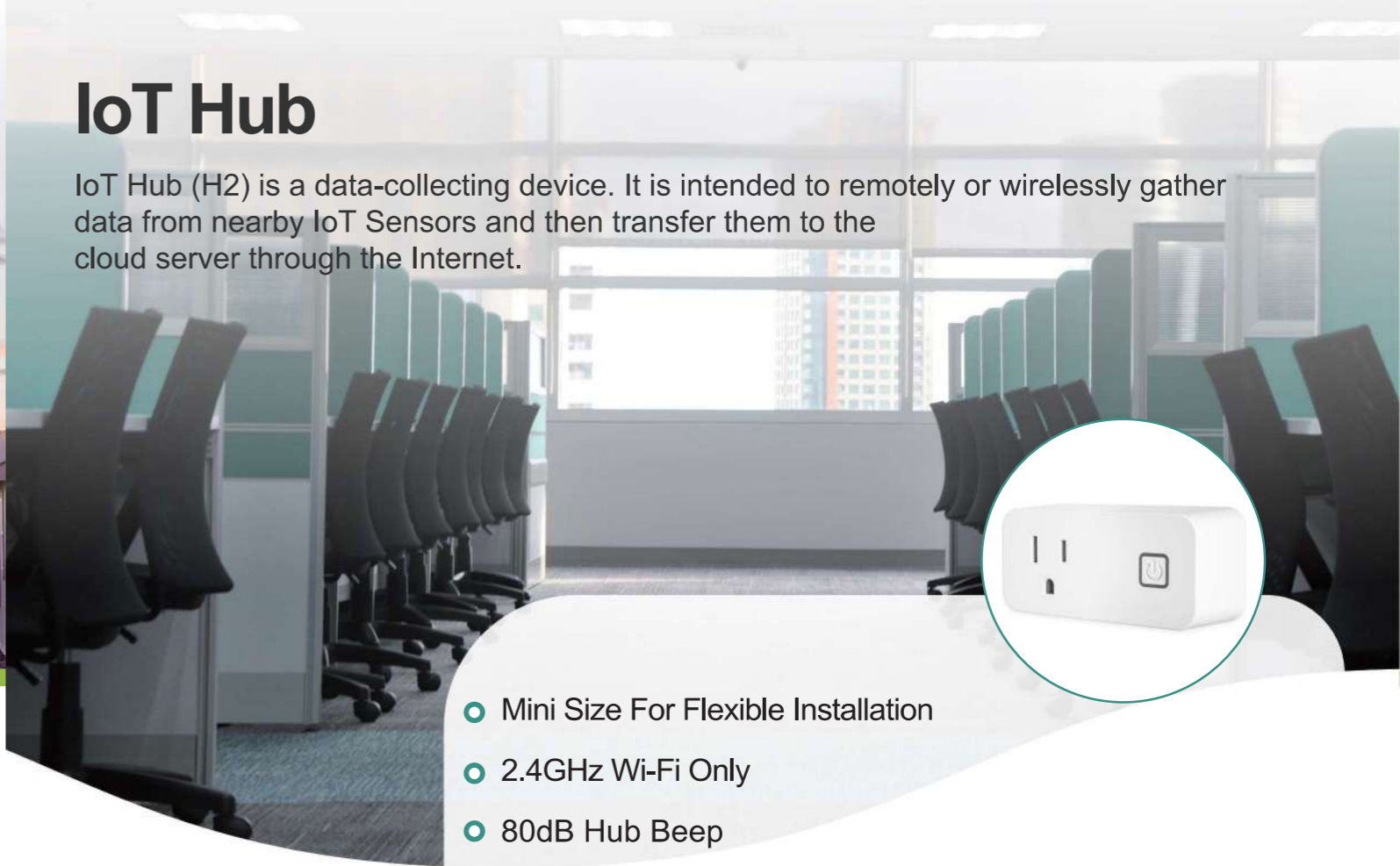

- Mini Size For Flexible Installation
- 2.4GHz Wi-Fi Only
- 80dB Hub Beep
- Manager Up To 30 Sensors

H2

Model	H2
Dimensions	3.46 x 1.48 x 2.05 inches
Weight	2.75 ounces
Input	100-240V~50/60Hz 10A
Output	100-240V~50/60Hz 10A
Wi-Fi Frequency	2.4 GHz
PAN Wireless Communication	Bluetooth Low Energy

IoT Hub

H5-Lite is MOCREO newest IoT Hub with display. On H5-Lite, you can visually monitor, access system status, and easily troubleshoot devices. It's a powerful data monitoring and interaction center that will bring you a new visualization and convenience experience.



- Local Monitoring
- 2.4GHz Wi-Fi Only
- 80dB Hub Beep
- Clear LCD Display
- Support External Sensor Probe

H5-Lite

Model	H5-Lite
Weight	2.75 ounces
Dimensions	3.46 x 1.48 x 2.05 inches
Input	100-240V 50/60Hz 10A
Output	100-240V~50/60Hz 10A
Wi-Fi Frequency	2.4 GHz
Communication	Bluetooth Low Energy
Screen	2-Inch LCD Screen
Supports	Up to 30 Sensors
Temperature Probe Measure Range	-40°F to 257°F
Accuracy	±0.9°F

Temperature Sensor

The MOCREO ST5 Temperature Sensor monitors real-time temperatures. Works with the MOCREO Hub.

With a 4.9-foot waterproof external probe, it's perfect for monitoring refrigerators, freezers, hot tubs, fish tanks, and pet cages.



- Temp Measuring Range -40°F~+221°F (-40°C~+105°C)
- BLE Wireless Connection To Hub
- 2-Year Battery Life
- High Accuracy
- Suitable for Freezer, Refrigerator Monitoring

ST5

Model	ST5
Dimensions	2.4 X 2.4 X0.7in (L x W x H)
Weight	2.92 Ounces
Battery	3.7 V 1800 mAh Lithium Battery; Rechargeable
Temp Measuring Range	-40°F ~ +221°F (-40°C ~ +105°C)
Accuracy	±1.8°F/±1°C (-22°F ~ 14°F/-30°C ~ -10°C) ±0.9°F/±0.5°C (14°F ~ 185°F/-10°C ~ 85°C) ±1.8°F/±1°C (185°F ~ 212°F/ 85°C ~ 100°C)
Resolution	0.5°C
Wireless Connection	BLE 4.2
Communication Distance	130ft/40m (No Obstacles)
Size of Stainless Steel Shell	6mm in diameter
Cable Length	1.5m
Cable Cross Section	4mm x1.3mm

Temperature Sensor

The MOCREO ST6 Temperature & Humidity Sensor measures temperature and humidity in real time.

Ideal for monitoring room, nurseries, vacation homes, HVAC systems, greenhouses, cabins, server rooms, warehouses, and wine cellars.



- Temp Measuring Range -40°F~+221°F (-40°C~+105°C)
- Humidity Measuring Range: 0 to 100%RH
- BLE Wireless Connection To Hub
- 2-Year Battery Life
- High Accuracy

ST6

Model	ST6
Dimensions	2.44 x 2.44 x 0.75 inches
Weight	1.94 ounces
Battery	3.7 V 1800 mAh Lithium, Rechargeable
Temperature Measuring Range	32°F to 140°F (0°C to 60°C)
Accuracy	±0.5°F / ±0.3°C
Humidity Measuring Range	0 to 100%RH (No Condensation)
Accuracy	±3%RH
Resolution	0.01°C / 0.01%RH
Wireless Connection	BLE 4.2 (ST6)
Communication Distance	130 ft (40 m), open space

Temperature Data Logger

The ST8 Temperature Data Logger is a practical temperature data logger designed to log ambient temperature sample at certain time interval. Support data exporting via Bluetooth.

When temperature exceed the limit, it will buzzer. Suitable for hospital pharmacies, vaccine storage, cold chain, warehouses, etc.



- 32,000 Temperature Points
- 110dB Local Beep
- High Accuracy
- Data Storage & Export
- Slim & Flat Probe Cable
- Bluetooth Connectivity
- 2-Year Battery Life

ST8

Model	ST8
Weight	3.70 ounces
Dimensions	3.86 x 1.82 x 0.88 inches (LxWxH)
Battery	9V 6LR61
Temperature Measuring Range	-40°F to 221°F (-40°C to 105°C)
Accuracy	±0.9°F (14°F to 185°F) / ±0.5°C (-10°C to 85°C) ±1.8°F (-22°F to 14°F) / ±1°C (-30°C to -10°C 185°F to 212°F / 85°C to 100°C)
Data Storage	32,000 temperature data points
Logging Interval	10 seconds to 16 hours (default 10 seconds)
Response Time	10 seconds
Wireless Connection	Bluetooth 4.2 BLE
Buzzer Level	110 dB

Temperature and Humidity Sensor

The MOCREO ST9 Thermohygrometer Sensor can measure ambient temperature and humidity in real time.

Equipped with IP67 waterproof probe, it is very suitable for high-humidity environments and reptile space: snake farms, geckos, lizards, bearded dragons, crawl space terrariums, turtle habitats, etc.



- Temp Measuring Range -40°F ~ 221°F (-40°C ~ 105°C)
- Humidity Measuring Range 0 to 100%RH
- BLE Wireless Connection To Hub
- 2-Year Battery Life
- IP67 Waterproof Probe Cable
- High Accuracy

ST9

Model	ST9
Weight	2.92 ounces
Dimensions	2.44 x 2.44 x 0.75 inches (L x W x H)
Battery	3.7V 1800mAh Lithium, Rechargeable
Temperature Measuring Range	-40°F to 221°F (-40°C to 105°C)
Accuracy	±0.5°F/±0.3°C
Resolution	0.01°C
Humidity Measuring Range	0 to 100%RH
Humidity Accuracy	±2%RH
Wireless Connection	BLE 4.2
Communication Distance	30 ft (40 m, no obstacles)
Cable Length	1.5 m

Ultra Low Temperature Sensor

The ST10 Temperature Sensor is specifically engineered for extremely low temperatures monitoring, enabling precise measurement to -328°F.

It is widely used in medical laboratory research, industrial monitoring and control, chain logistics, etc.



- Temp Measuring Range -328°F ~ 392°F (-200°C ~ 200°C)
- Ultra Low Temperature Probe
- BLE Wireless Connection To Hub
- 2-Year Battery Life
- High Accuracy

ST10

Model	ST10
Weight	2.92 ounces
Dimensions	2.44 x 2.44 x 0.75 inches (L x W x H)
Battery	3.7V 1800mAh Lithium, Rechargeable
Temperature Measuring Range	-328°F ~ 392°F (-200°C ~ 200°C)
Accuracy	±1.8°F (±1°C)
Resolution	0.01°C
Wireless Connection	BLE 4.2
Communication Distance	130ft/40m (No Obstacles)
Cable Length	1.5m
Cable Cross Section	4mm x 1.3mm

Water Leak Sensor

SW2 is equipped with two sensitive inductive probes that can detect and alarm instantly. The 39-inch (1 meter) waterproof probe can easily reach into small corners, such as under a washing machine or next to a dishwasher.



- Water Leakage Detection
- Two Alarm Modes: Water/No water
- 95dB Local Beep
- BLE Wireless Connection To Hub
- 2-Year Battery Life

SW2

Model	SW2
Dimensions	2.44 x 2.44 x 0.75in (L x W x H)
Weight	2.89 Ounces
Battery	3.7 V 1800 mAh Lithium Battery; Rechargeable
Working Temperature Range	14°F~131°F(-10°C~55°C)
Wireless Connection	BLE 4.2
Communication Distance	131ft/40m (No Obstacles)
Alarm Level	95dB
Cable Length	1.5m
Cable Cross Section	4mm x 1.3mm

WiFi Thermometer

The NS1 Wi-Fi Thermometer is equipped with a color IPS LCD display that easily to know the current temperature at a glance.

Ideal for use in refrigerators, freezers, bathtubs, fish tanks, and various other environments.



- Temp Measuring Range -40°F~+221°F (-40°C~+105°C)
- Wi-Fi Connection(2.4GHz WiFi Only)
- LCD Smart Display
- Remote Monitoring & Local Monitoring

NS1

Model	NS1
Button	Physical Button *1
LCD Display	1.54-inch, 240 * 240 IPS display, non touch
Network	2.4 GHz Wi-Fi
Dimensions	2.07×1.72 x 0.46 inches (L x W x H)
Weight	3.63 Ounces
Temp Measuring Range	-40°F-257°F (-40°C -125°C)
Accuracy	±0.9°F
Power	5V/1A USB Adapter

LoRa IoT Hub

The MOCREO H5-Pro LoRa Hub is a versatile gateway that connects various sensors to the LoRaWAN network, ensuring robust, long-range, and low-power communication for efficient and reliable data monitoring and management.



- LoRa Long Range Network
- 2.4GHz WiFi/Ethernet Connection
- 80dB Hub Beep
- Clear LCD Display
- Support Up To 50 Sensors

LoRa Temperature Sensor

The MOCREO LoRa Temperature Sensor provides accurate, real-time temperature monitoring over long distances with minimal power consumption. Ideal for various applications.



- Temp Measuring Range -40°F~+221°F (-40°C~+105°C)
- LoRa Wireless Connection To Hub
- IP67 Waterproof Level
- 2-Year Battery Life

H5-Pro

Model	H5-Pro
Weight	2.75 ounces
Dimensions	3.46 x 1.48 x 2.05 inches
Input	100-240V 50/60Hz 10A
Output	100-240V 50/60Hz 10A
Communication	LoRaWAN
Wi-Fi Frequency	2.4 GHz
Screen	2-Inch LCD Screen
Supports	Up to 50 Sensors

LS1

Model	LS1
Dimensions	4.20 x 2.22 x 0.78 inches
Weight	3.70 Ounces
Battery	3*AAA battery
Wireless Connection	LoRa
Communication Range	131ft/40m
Waterproof Level	P67
Temp Measuring Range	-40°F ~ 257°F (-40°C ~ 125°C)
Accuracy	±0.9°F

LoRa Temperature & Humidity Sensor

The MOCREO LoRa Temperature & Humidity Sensor offers precise, real-time monitoring of temperature and humidity across long distances with low power usage.



- Temp Measuring Range -40°F~+221°F (-40°C~+105°C)
- Humidity Measuring Range: 0 to 100%RH
- LoRa Wireless Connection To Hub
- IP67 Waterproof Level
- 2-Year Battery Life

LS2

Model	LS2
Dimensions	4.20 x 2.22 x 0.78 inches
Weight	3.70 Ounces
Battery	3*AAA battery
Wireless Connection	LoRa
Communication Range	131ft/40m
Waterproof Level	P67
Temp Measuring Rage	32°F to 140°F (0°C to 60°C)
Accuracy	±0.5°F / ±0.3°C
Humidity Measuring Range	0 to 100%RH (No Condensation)
Accuracy	±3%RH

LoRa Water Leak Sensor

The MOCREO LoRa Water Leak Sensor offers prompt water leak detection over long distances with minimal power consumption.



- Water Leakage Detection
- LoRa Wireless Connection To Hub
- Two Alarm Modes: Water/No water
- 95dB Local Beep
- IP67 Waterproof Level
- 2-Year Battery Life

LS3

Model	LS3
Dimensions	4.20 x 2.22 x 0.78 inches
Weight	3.70 Ounces
Battery	3*AAA battery
Wireless Connection	LoRa
Communication Range	131ft/40m
Waterproof Level	P67
Temp Measuring Rage	-40°F ~ 257°F (-40°C ~ 125°C)
Accuracy	±0.9°F

Temperature Controller

The ST7-CL Temperature Controller controls the environment temperature by switching the outlet on/off, to keep the environmental temperature at the range set.

Suitable for: fermentation, incubator, home brewing, pet breeding, and more



- Temp Measuring Range -40°F~+221°F (-40°C~+105°C)
- Outlet Switch ON/OFF Automatically
- Temperature Threshold Set
- 90DB Loud Alarm

Network Monitor

The NM1 Router Rebooter is a control outlet plug that addresses the issue of network disruptions. It possesses the capability to automatically monitor the status of the network connection and initiate a power reset in the event of a malfunction, thereby restoring the network connection.



- Automatic Network Monitoring & Reboot
- Programmable
- Instant Email Notifications
- Easy to Use
- No internet connection required, ensuring data security

ST7-CL

Model	ST7-CL
Weight	2.65 ounces
Dimensions	3.28 x 2.05 x 1.48 inches
Temp Measuring Range	-40°F~+221°F (-40°C~+105°C)
Operating Temperature Range	14°F to 50°F (-10°C to 40°C)
Input	AC 100-240V 50/60Hz
Output	AC 100-240V 50/60Hz 10A
Accuracy	±0.9°F/±0.5°C
Cable Length	4.92 ft
Buzzer Volume	90 dB

NM1

Model	NM1
Weight	2.75 ounces
Dimensions	3.46 x 1.48 x 2.05 inches (L x W x H)
Input	AC 100 – 240V 50/60HZ
Output	AC 100 – 240V 20/60HZ 10A
Wi-Fi Frequency	2.4 GHz
Working Temperature	14°F to 50°F (-10°C to 40°C)
Working Humidity	0 – 90%RH, no condensation